

BASIC

VALVOLA A SFERA A PASSAGGIO TOTALE SERIE UNIVERSALE FULL BORE BALL VALVE UNIVERSAL SERIES

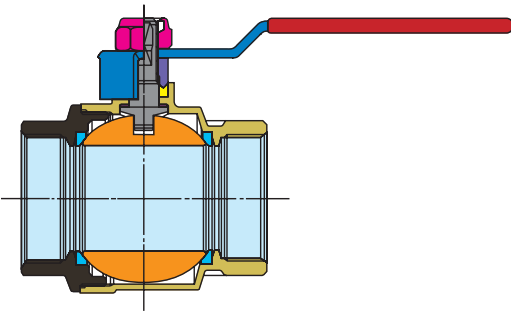

SPECIFICA MATERIALI MATERIAL SPECIFICATION



PARTICOLARI COMPONENT

MATERIALI MATERIAL

DESCRIZIONE DESCRIPTION

■ CORPO BODY	CW 617 N UNI EN 12165	STAMPATO DA BARRA, NICHELATO Forged, Nickel-Plated
■ MANICOTTO END ADAPTER	CW 617 N UNI EN 12165	STAMPATO DA BARRA, NICHELATO Forged, Nickel-Plated
■ SFERA BALL	CW 614 N UNI EN 12164	DA BARRA, NICHEL-CROMATA Machined, Chrome-Plated
■ SEDI LATERALI BALL GASKETS	PTFE	VERGINE Virgin
■ PERNO STEM	CW 614 N UNI EN 12164	DA BARRA Machined
■ ANELLO ANTIFRIZIONE THRUST WASHER	PTFE	VERGINE Virgin
■ GUARNIZIONE DI TENUTA SUP. STEM PACKING	PTFE	VERGINE Virgin
■ PREMIGUARNIZIONE GLAND	CW 614 N UNI EN 12164	DA BARRA, NICHELATO Machined, Nickel-Plated
■ LEVA LEVER HANDLE	ACCIAIO ZINCATO Zinc-Plated Steel	PLASTIFICATA IN PVC Pvc Insulated
■ FARFALLA O LEVA LEVER OR T-HANDLE	ALLUMINIO Aluminium	VERNICIATA Painted
■ DADO AUTO-BLOCCANTE SELF-LOCKING NUT	ACCIAIO Steel	ZINCATO Zinc-Plated

FILETTATURE

Estremità filettate UNI ISO 228/1.

END CONNECTIONS

Threaded ends UNI ISO 228/1.

IMPIEGHI

Le valvole a sfera **BASIC** sono adatte per l'uso con acqua calda e fredda, aria compressa, oli e idrocarburi in generale. Per utilizzi speciali vedere le tabelle di compatibilità chimica.

APPLICATIONS

The **BASIC** ball valves are suitable for hot and cold water, compressed air, oils and hydrocarbons in general. For special uses please see the chemical resistance tables.

PRESSIONE DI ESERCIZIO

Da PN 80 (1/4") a PN 16 (4").
Vedere diagramma pressione/temperatura.

PRESSURE LIMITS

From PN 80 (size 1/4") to PN 16 (size 4").
See pressure/temperature diagram.

LIMITI DI TEMPERATURA

Da -20°C a +150°C.
Vedere diagramma pressione/temperatura.

TEMPERATURE LIMITS

From -20°C to + 150°C.
See pressure/temperature diagram.

FORO ANTILEGIONELLA DAL 1/2" AL 2" - ANTI LEGIONELLA HOLE FROM 1/2" TO 2"

Diagramma pressione/temperatura (prova eseguita con acqua)
Pressure/temperature diagram (tested with water)



Diagramma perdite di carico (prova eseguita con acqua)
Loss of head diagram (tested with water)



BASIC

VALVOLA A SFERA A PASSAGGIO TOTALE SERIE UNIVERSALE FULL BORE BALL VALVE UNIVERSAL SERIES

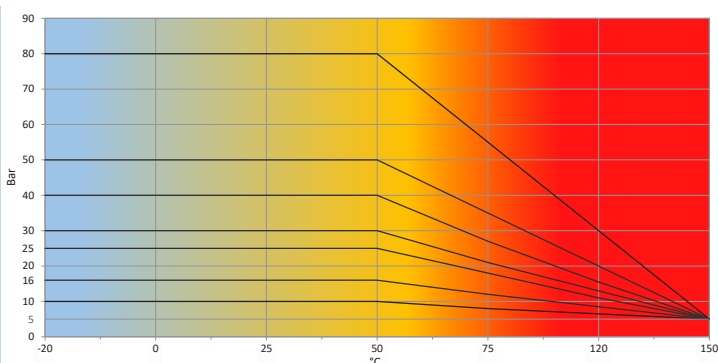
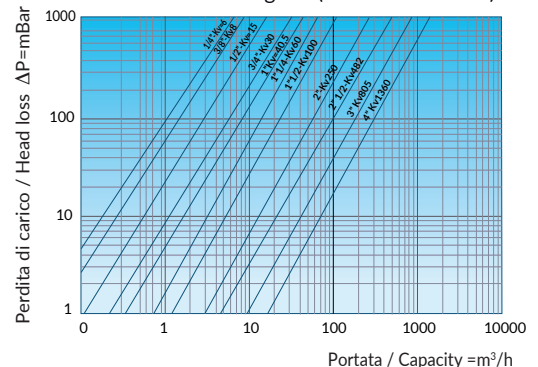
S0211 BASIC

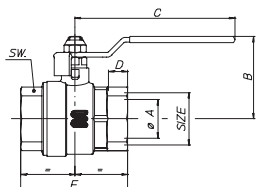

CODICE CODE	MISURA SIZE	PN Bar	øA	B	C	D	E	SW	Box Crt
S0211N02	¼" (DN10)	80	10	38	90	11	47,5	17	25/125
S0211N03	⅜" (DN10)	80	10	38	90	11,4	49,5	21	25/100
S0211N04	½" (DN 15)	50	15	39,5	90	9,5	49	25	15/75
S0211N05	¾" (DN20)	50	20	47,5	105	11	59	31	12/48
S0211N06	1" (DN25)	50	25	51,5	105	12,5	70	38	12/36
S0211N07	1¼" (DN32)	50	32	62	120	13,5	81	47	4/20
S0211N08	1½" (DN40)	40	40	71	140	15,5	94	54	4/8
S0211N09	2" (DN50)	40	50	85,5	170	17,5	112	66	2/8
S0211N10	2½" (DN65)	40	65	98,5	170	19,5	134	83	1/6
S0211N11	3" (DN82)	25	80	112,5	250	21	156	97	1/3
S0211N12	4" (DN100)	16	100	135,5	250	24,3	189	124	1/1

Valvola a sfera passaggio totale con leva acciaio, femmina/femmina, nichelata.
Full bore valve with steel handle, female/female, nickel-plated.

S0212 BASIC

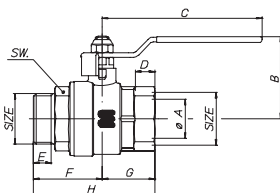

CODICE CODE	MISURA SIZE	PN Bar	øA	B	C	D	E	F	G	H	SW	Box Crt
S0212N04	½" (DN 15)	50	15	39,5	90	9,5	9,7	34,75	24,5	59,5	25	15/75
S0212N05	¾" (DN20)	50	20	47,5	105	11	10,7	40,5	29,5	70	31	12/48
S0212N06	1" (DN25)	50	25	51,5	105	12,5	11,7	44,5	35	79,5	38	8/32
S0212N07	1¼" (DN32)	50	32	62	120	13,5	13,2	47,5	40,5	88	47	4/20
S0212N08	1½" (DN40)	40	40	71	140	15,5	15,5	54,5	47	101,5	54	4/8
S0212N09	2" (DN50)	40	50	85,5	170	17,5	17,5	65	56	121	66	2/8

Valvola a sfera passaggio totale con leva acciaio, maschio/femmina, nichelata.
Full bore valve with steel handle, male/female, nickel-plated.

S0214 BASIC

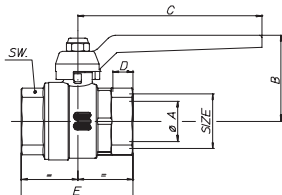

CODICE CODE	MISURA SIZE	PN Bar	øA	B	C	D	E	SW	Box Crt
S0214N02	¼" (DN10)	80	10	38,5	80	11	47,5	17	25/125
S0214N03	⅜" (DN10)	80	10	38,5	80	11,4	49,5	21	25/125
S0214N04	½" (DN 15)	50	15	40	80	9,5	49	25	15/75
S0214N05	¾" (DN20)	50	20	49,5	115	11	59	31	12/48
S0214N06	1" (DN25)	50	25	53,5	115	12,5	70	38	12/48
S0214N07	1¼" (DN32)	50	32	64	130	13,5	81	47	4/20
S0214N08	1½" (DN40)	40	40	74,5	150	15,5	94	54	4/8
S0214N09	2" (DN50)	40	50	90	170	17,5	112	66	2/8
S0214N10	2½" (DN65)	40	65	105,5	170	19,5	134	83	1/5
S0214N11	3" (DN82)	25	80	119,5	235	21	156	97	1/3
S0214N12	4" (DN100)	16	100	142	235	24	189	124	1/2

Valvola a sfera passaggio totale con leva alluminio, femmina/femmina, nichelata.
Full bore ball valve with aluminium lever, female/female, nickel-plated.

BASIC

VALVOLA A SFERA A PASSAGGIO TOTALE SERIE UNIVERSALE FULL BORE BALL VALVE UNIVERSAL SERIES

S0215 BASIC

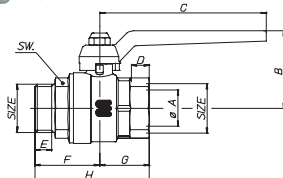

CODICE CODE	MISURA SIZE	PN Bar	øA	B	C	D	E	F	G	H	SW	Box Crt
S0215N04	½" (DN 15)	50	15	40	80	9,5	9,7	34,75	24,5	59,5	25	15/75
S0215N05	¾" (DN20)	50	20	49,5	115	11	10,7	40,5	29,5	70	31	12/48
S0215N06	1" (DN25)	50	25	53,5	115	12,5	11,7	44,5	35	79,5	38	8/32
S0215N07	1"¼ (DN32)	50	32	64	130	13,5	13,2	47,5	40,5	88	47	4/20
S0215N08	1"½ (DN40)	40	40	74,5	150	15,5	14,7	54,5	47	101,5	54	4/8
S0215N09	2" (DN50)	40	50	90	170	17,5	16,7	65	56	121	66	2/8

Valvola a sfera passaggio totale con leva alluminio, maschio/femmina, nichelata.
Full bore ball valve with aluminium lever, male/female, nickel-plated.

S0217 BASIC

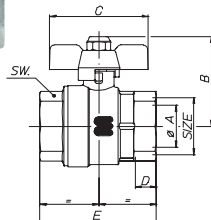

CODICE CODE	MISURA SIZE	PN Bar	øA	B	C	D	E	SW	Box Crt
S0217N02	¼" (DN10)	80	10	34,5	52	11	47,5	17	30/150
S0217N03	⅜" (DN10)	80	10	34,5	52	11,4	49,5	21	28/140
S0217N04	½" (DN 15)	50	15	38	52	9,5	49	25	15/75
S0217N05	¾" (DN20)	50	20	47	65	11	59	31	12/48
S0217N06	1" (DN25)	50	25	51	65	12,5	70	38	9/36

Valvola a sfera passaggio totale con farfalla, femmina/femmina, nichelata.
Full bore ball valve with T-handle, female/female, nickel-plated.

S0218 BASIC

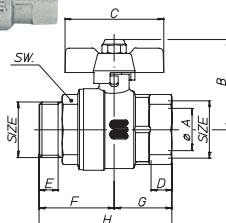
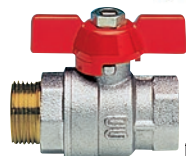

CODICE CODE	MISURA SIZE	PN Bar	øA	B	C	D	E	F	G	H	SW	Box Crt
S0218N04	½" (DN 15)	50	15	38	52	9,5	9,7	34,75	24,5	59,5	25	20/100
S0218N05	¾" (DN20)	50	20	47	65	11	10,7	40,5	29,5	70	31	12/48
S0218N06	1" (DN25)	50	25	51	65	12,5	11,7	44,5	35	79,5	38	9/36

Valvola a sfera passaggio totale con farfalla, maschio/femmina, nichelata.
Full bore ball valve with T-handle, male/female, nickel-plated.

S0226 BASIC

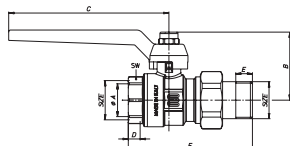

CODICE CODE	MISURA SIZE	PN Bar	øA	B	C	D	E	F	SW	Box Crt
S0226N04	¾" (DN15)	50	20	50,5	115	11	12	89	31	12/60
S0226N05	1" (DN 20)	50	25	54,5	115	12,5	14	110	38	8/40
S0226N06	1"¼ (DN25)	50	32	61	115	13,5	15	124,5	47	6/24

Valvola a sfera per collettori femmina/codola maschio con O-ring
con leva alluminio rossa, nichelata.

Full bore ball valve with nut and tail with O-ring,
with aluminium lever, female with nut and tail, nickel-plated.

BASIC

VALVOLA A SFERA A PASSAGGIO TOTALE SERIE UNIVERSALE FULL BORE BALL VALVE UNIVERSAL SERIES

S0227 BASIC

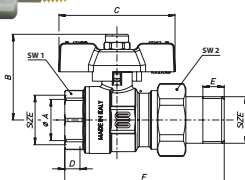

CODICE CODE	MISURA SIZE	PN Bar	øA	B	C	D	E	F	SW1-2	Box Crt
S0227N04	½" (DN 15)	50	15	48	52	11	12	89	31-38	12/60
S0227N05	¾" (DN20)	50	20	52	65	12,5	14	110	38-47	10/40
S0227N06	1" (DN25)	50	25	59,5	65	13,5	15	124,5	47-52	6/30

Valvola a sfera per collettori femmina/codola **completa con O-ring** con farfalla rossa, nichelata.
Full bore ball valve with nut and tail **with O-ring**, with T-handle, female with nut and tail, nickel-plated.

S3226 BASIC

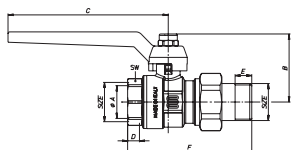

CODICE CODE	MISURA SIZE	PN Bar	øA	B	C	D	E	F	SW	Box Crt
S3226N04	½" (DN 15)	50	15	41	80	9,5	10	77	25	12/60
S3226N05	¾" (DN20)	50	20	50,5	115	11	12	89	31	8/32
S3226N06	1" (DN25)	50	25	54,5	115	12,5	14	110	38	6/24
S3226N07	1 ¼" (DN32)	50	32	61	115	13,5	15	124,5	47	4/8

Valvola a sfera per collettori femmina/codola maschio **con sede piana** con leva alluminio rossa, nichelata.
Full bore ball valve with nut and tail **with flat seat**, with aluminium lever, female with nut and tail, nickel-plated.

S3227 BASIC

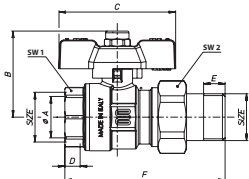

CODICE CODE	MISURA SIZE	PN Bar	øA	B	C	D	E	F	SW1-2	Box Crt
S3227N04	½" (DN 15)	50	15	39	52	9,5	10	77	25-31	12/60
S3227N05	¾" (DN20)	50	20	48	65	11	12	89	31-38	10/40
S3227N06	1" (DN25)	50	25	52	65	12,5	14	110	38-47	6/30
S3227N07	1 ¼" (DN32)	50	32	59,5	65	13,5	15	124,5	47-52	5/20

Valvola a sfera per collettori femmina/codola **con sede piana** con farfalla rossa, nichelata.
Full bore ball valve with nut and tail **with flat seat**, with T-handle, female with nut and tail, nickel-plated.

S0228 BASIC

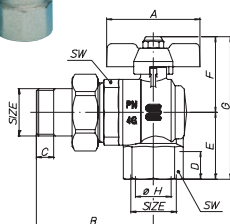

CODICE CODE	MISURA SIZE	PN Bar	A	B	C	D	E	F	G	øH	SW	Box Crt
S0228N04	½" (DN 15)	16	52	60,5	10	15	33	40	73	15	26	15/60
S0228N05	¾" (DN20)	16	65	67,5	12	16,3	39	49	88	20	32	10/20
S0228N06	1" (DN25)	16	65	78	12	19,1	46,5	53	99,5	25	39	5/20

Valvola a sfera a squadra per collettori femmina/codola maschio **completa con o-ring** con farfalla rossa, nichelata.
Angle full bore ball valve with nut and tail assembled with o-ring, with T-handle, female/male with nut and tail, nickel-plated.

BASIC

VALVOLA A SFERA A PASSAGGIO TOTALE SERIE UNIVERSALE FULL BORE BALL VALVE UNIVERSAL SERIES

S0229 BASIC

euofins ACS EAC

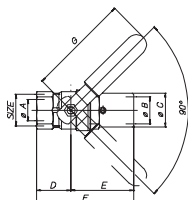

CODICE CODE	MISURA SIZE	PN Bar	øA	øB	øC	D	E	F	G	Box Crt
S3229N05	¾" (DN20)	10	17,5	22,3	29,5	30	55	85	90	12/48

Valvola a sfera femmina/manicotto cilindrico liscio con leva acciaio rossa, nichelata., per friggitrice
Female ball valve for deep fryers, with red steel lever, nickel-plated., for fryers.

S0320 MINI PUMP



Temperatura: Max 90°C
Temperature: Max 90°C

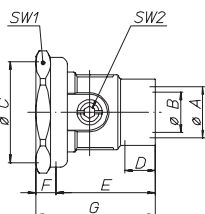

CODICE CODE	MISURA SIZE	PN Bar	øA	øB	øC	D	E	F	G	SW1-2	Box Crt
S0320S06	1"½x1" (DN 18)	10	1"	19	1"½	15,7	49	9,5	58,5	52-5	12/60

Valvola a sfera fil. femmina con flangia per attacco pompe, con girello, sabbata.
Ball valve for pumps, female threaded, with hexagonal nut.

S0460 BASIC BRAVO

euofins ACS EAC

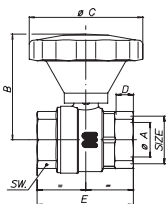

CODICE CODE	MISURA SIZE	PN Bar	øA	B	øC	D	E	SW	Box Crt
S0460N02	¼" (DN10)	80	10	67	82	7	38	17	6/30
S0460N03	⅜" (DN10)	80	10	67	82	8,5	43	21	6/24
S0460N04	½" (DN 15)	50	15	68	82	9,5	49	25	6/24
S0460N05	¾" (DN20)	50	20	74	82	11	59	31	6/24
S0460N06	1" (DN25)	50	25	78	82	12,5	70	38	4/20
S0460N07	1"¼ (DN32)	50	32	114,5	128	13,5	81	47	1/7
S0460N08	1"½ (DN40)	40	40	121	128	15,5	94	54	1/5
S0460N09	2" (DN50)	40	50	130	128	17,5	112	66	1/5

Valvola a sfera a passaggio totale con manopola di riduzione BRAVO, femmina/femmina, nichelata.
Full bore ball valve with BRAVO gear handle, female/female, nickel-plated.

S3311 BASIC

euofins ACS EAC

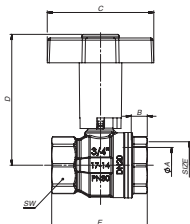

CODICE CODE	MISURA SIZE	PN Bar	øA	B	C	D	E	SW	Box Crt
S3311N04	½" (DN 15)	30	15	9	60	69,5	46,5	24	12/60
S3311N05	¾" (DN20)	30	20	10,5	60	73,5	54	30	10/40
S3311N06	1" (DN25)	30	25	12	80	77,5	65	37	10/40

Valvola a sfera passaggio totale, femmina/femmina con prolunga in plastica.
Full bore ball valve with plastic extended stem, female/female, nickel-plated.

BASIC

VALVOLA A SFERA A PASSAGGIO TOTALE SERIE UNIVERSALE FULL BORE BALL VALVE UNIVERSAL SERIES

S3251 BASIC

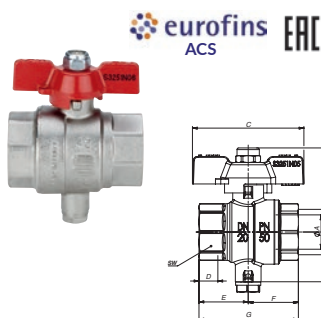

CODICE CODE	MISURA SIZE	PN Bar	A	B	C	D	E	F	G	H	SW	Box Crt
S3251N05	3/4" (DN20)	50	20	49	65	11	28,7	29,3	58	29	31	12/60
S3251N06	1" (DN25)	50	25	53,5	65	12,5	34,5	35	69,5	33	38	10/40

Valvola a sfera passaggio totale, femmina/femmina con attacco sonda (M10), nichelata.
Full bore ball valve, female/female, with gage port, nickel-plated.

S1361 BASIC



Temperatura: -20°C / + 130°C
Temperature: -20°C / + 130°C

CODICE CODE	MISURA SIZE	PN Bar	øA	B	C	D	E	SW	Box Crt
S1361N35	3/4" (DN 20)	30	20	56	66	16,3	70	31	6/30
S1361N36	1" (DN 25)	30	25	60	66	19,1	83	38	6/30

Tempi di consegna da concordare | Delivery time to be agreed

Valvola a sfera a passaggio totale con serratura, femmina/femmina, nichelata.
Full bore ball valve with key-locking device, female/female, nickel-plated.

FINO AD ESAURIMENTO SCORTE | UNTIL STOCK END

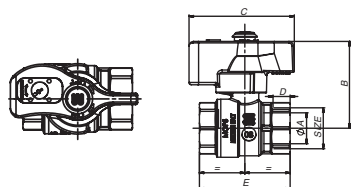

S1362 BASIC



Temperatura: -20°C / + 130°C
Temperature: -20°C / + 130°C

CODICE CODE	MISURA SIZE	PN Bar	øA	B	C	D	E	F	G	H	SW	Box Crt
S1362N35	3/4" (DN 20)	30	20	56	66	16,3	14,5	42,5	35	77,5	32-39	6/30
S1362N36	1" (DN 25)	30	25	60	66	19,1	16,8	47,5	41,5	89	31-38	6/30

Tempi di consegna da concordare | Delivery time to be agreed

Valvola a sfera a passaggio totale con serratura, maschio/femmina, nichelata.
Full bore ball valve with key-locking device, male/female, nickel-plated.

FINO AD ESAURIMENTO SCORTE | UNTIL STOCK END

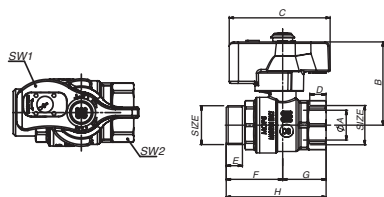

VANTAGGI

Sistema di chiusura sicuro. Sistema di morosità pratico e veloce, che evita il laborioso fissaggio, mediante la tradizionale piombatura con il filo. Due chiavi per l'utente (di colore grigio) fornite insieme alla valvola. Una chiave maestra per il responsabile dell'impianto che funge sia da passepartout che da morosità (di colore giallo) fornita solo a richiesta. N° 100 combinazioni sotto la stessa chiave maestra.

ADVANTAGES

Safe locking device. Practical and rapid arrearage system which replaces the laborious fixing through the traditional wire-leading. Two grey keys are given to the user together with the valve. The person in charge of the system can receive a master key, which suits all the locks and can be used in case of arrearage. It is a yellow key and it is available only upon request. The same yellow key can be used for 100 different combinations.

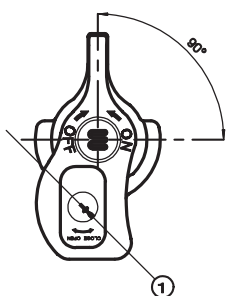

1 - POSIZIONE NORMALE

Con la chiave in questa posizione la valvola funziona normalmente ON-OFF e la chiave NON PUÓ essere estratta.

1 - NORMAL POSITION

When the key is in this position, the valve works normally ON-OFF and the key itself CANNOT be taken away.

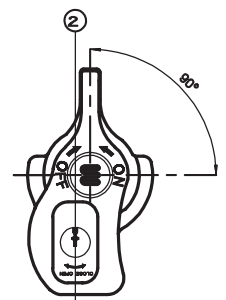

2 - POSIZIONE DI BLOCCAGGIO UTENTE

Con la chiave in questa posizione la valvola può essere bloccata in posizione OFF e la chiave PUÓ essere estratta.

2 - USER LOCKING POSITION

When the key is in this position, the valve can be locked in the OFF position and the key CAN be taken away.

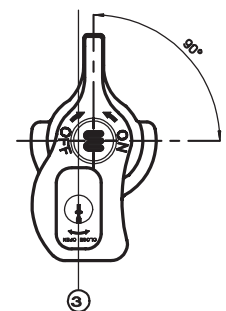

3 - POSIZIONE DI MOROSITÀ POSIZIONE ATTIVABILE CON LA SOLA CHIAVE PASSEPARTOUT

Con la chiave in questa posizione la valvola può essere bloccata in posizione OFF e NON PUÓ essere bloccata con la chiave utente.
(Chiave gialla in dotazione all'ente erogatore)

3 - ARREARAGE POSITION ONLY THE MASTER KEY CAN ACTIVATE THE POSITION

When the key is in this position, the valve can be locked in the OFF position and it CANNOT be locked with the user's key.

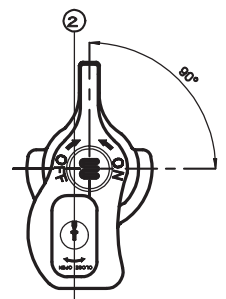

4 - RITORNO POSIZIONE NORMALE

Con la chiave riportata in posizione 2 dall'ente erogatore la valvola ritorna a funzionare normalmente.

4 - RETURN TO THE NORMAL POSITION

When the key is put back in the second position by the supplier, the valve can work normally.

